

MEC[™] Excelsa-Flange Series Valve Installation Tool

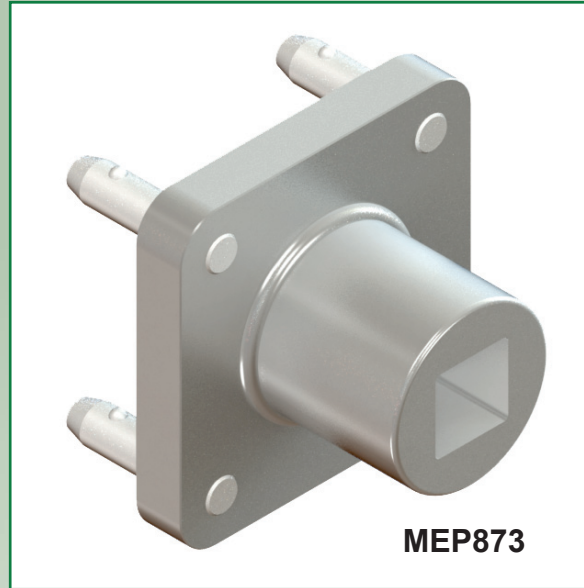

Throw away that pipe wrench for *GOOD!*

APPLICATION:

The MEP873 is intended to fit all Excelsa-Flange[™] type A flange tank valves. This tool is designed to fit snugly into each of the 4 type A smooth bore flange bolt holes with individual posts. Each replaceable post features a self-retaining spring action ball detent to hold the tool firmly in place while attached to the Excelsa-Flange[™] valve and has rubber cushioning pads to prevent direct contact with sealing surfaces. The MEP873 features a robust 1" square socket drive for use with even the most heavy duty impact or socket wrenches.

Part No.	Description
MEP873	4 Bolt Type A Flange Valve Installation Tool w/ 1" Square Drive
MEP873-102	Replacement Torque Posts

