

ME663SRK
DOUBLE CHECK VAPOR EQUALIZING
VALVE SEAL REPAIR KIT

!!!WARNING!!!

READ AND UNDERSTAND ALL INSTRUCTIONS INCLUDED WITH THIS REPAIR KIT
 RELIEVE ALL PRESSURE FROM SYSTEM BEFORE REMOVING VALVE FOR SERVICE

NOTE: Numbers in brackets [] refer to the number in the valve component list.

A. Disassembly

- 1. EVACUATE ALL PRESSURE FROM SYSTEM BEFORE ANY DISASSEMBLY OR REPAIR.**
2. Remove Acme Cap [7] from Bonnet [2] and retain.
3. Remove Acme Gasket [6] from Bonnet [2] and discard.
4. Remove Bonnet [2] from Body [1] and retain.
5. Remove Molded Valve [4], Spring [5], and Nylon Seal [3] from Body [1] and discard.
6. Inspect Body [1] and Bonnet [2] and clean if necessary, be sure interior is free of dirt, residue, and foreign particles.

B. Reassembly

1. Install Nylon Seal [3] into Body [1].
2. Install Spring [5] into Body [1].
3. Install Molded Valve [4] into Body [1] in direction shown.
4. Apply Loctite #271 or equivalent thread locker to threads of Bonnet [2].
5. Install Bonnet [2] into Body [1] and torque to 50±5 ft-lbs.
6. Install Acme Gasket [6] into Bonnet [2].
7. Connect the valve assembly outlet to a pressure source of at least 150 PSI. Check for leaks at all joints using a suitable leak detector solution such as "Marshall Excelsior" leak detector.

C. Component List

1. Body
2. Bonnet
3. Nylon Seal
4. Molded Valve
5. Spring
6. Acme Gasket
7. Acme Cap



WARNING: These products contain a chemical known to the state of California to cause cancer and birth defects or reproductive harm

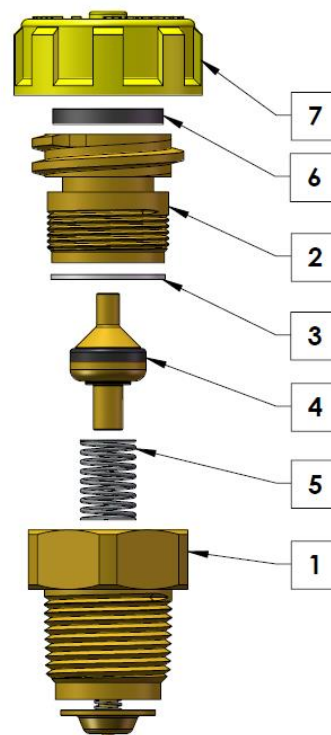

Marshall Excelsior Company

1506 George Brown Drive Marshall, MI 49068
 Phone (269) 789-6700 Fax (269) 781-8340
www.marshallexcelsior.com

The contents of this publication are for informational purposes only. While every effort has been made to ensure accuracy, these contents are not to be construed as warranties or guarantees, expressed or implied, regarding the products or services described herein or for their use or applicability. Marshall Excelsior Co. reserves the right to modify or improve the designs or specifications of such products at any time without notice. The MEC™ logo is the trademark of Marshall Excelsior Co.