

**ME662-901K**  
**DOUBLE CHECK FILL VALVE**  
**REPLACEMENT KIT**

**!!!WARNING!!!**

READ AND UNDERSTAND ALL INSTRUCTIONS INCLUDED WITH THIS REPAIR KIT  
RELIEVE ALL PRESSURE FROM SYSTEM BEFORE REMOVING VALVE FOR SERVICE

**NOTE:** Numbers in brackets [ ] refer to the number in the valve component list.

**A. Disassembly**

1. **EVACUATE ALL PRESSURE FROM SYSTEM BEFORE ANY DISASSEMBLY OR REPAIR.**
2. Remove Filler Valve Assembly [3] and Nylon Seal [2] from Body [1] and discard
3. Inspect Body [1] and clean if necessary, be sure interior is free of dirt, residue, and foreign particles.

**B. Reassembly**

1. Install Nylon Seal [2] into Body [1].
2. Apply Loctite #271 or equivalent thread locker to threads of Filler Valve Assembly [3] and install into Body [1] and torque to 100±5 ft-lbs.
3. Connect the valve assembly outlet to a pressure source of at least 150 PSI. Check for leaks at all joints using a suitable leak detector solution such as “Marshall Excelsior” leak detector.  
**CAUTION: DO NOT USE THE VALVE IF ANY JOINT CONTINUES TO LEAK UNDER PRESSURE.**

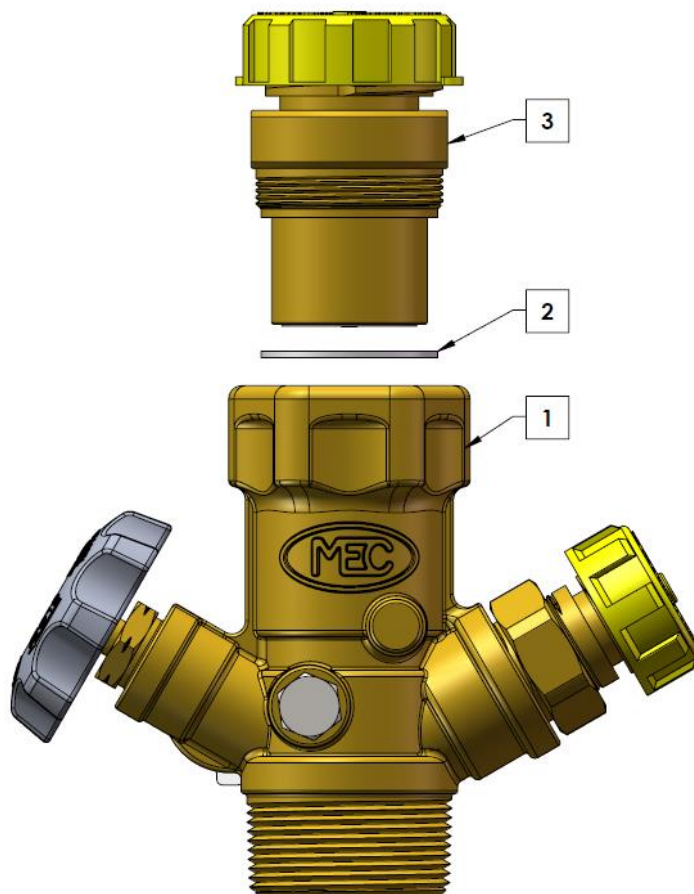

**C. Component List**

1. Body
2. Nylon Seal
3. Filler Valve Assembly



**WARNING:** These products contain a chemical known to the state of California to cause cancer and birth defects or reproductive harm

**Marshall Excelsior Company**  
1506 George Brown Drive Marshall, MI 49068  
Phone (269) 789-6700 Fax (269) 781-8340  
[www.marshallexcelsior.com](http://www.marshallexcelsior.com)

The contents of this publication are for informational purposes only. While every effort has been made to ensure accuracy, these contents are not to be construed as warranties or guarantees, expressed or implied, regarding the products or services described herein or for their use or applicability. Marshall Excelsior Co. reserves the right to modify or improve the designs or specifications of such products at any time without notice. The MEC™ logo is the trademark of Marshall Excelsior Co.