

**ME670-HRK HANDLE REPAIR KIT  
FOR: ME670 THRU ME673 SERIES  
FILL AND WITHDRAWAL VALVES**

**!!!WARNING!!!**

READ AND UNDERSTAND ALL INSTRUCTIONS INCLUDED WITH THIS REPAIR KIT  
RELIEVE ALL PRESSURE FROM SYSTEM BEFORE REMOVING VALVE FOR SERVICE

**NOTE:** Numbers in brackets [ ] refer to the number in the valve component list.



**WARNING:** These products contain a chemical known to the state of California to cause cancer and birth defects or reproductive harm

**A. Disassembly**

1. **EVACUATE ALL PRESSURE FROM SYSTEM BEFORE ANY DISASSEMBLY OR REPAIR.**
2. Remove Hex Nut [8], Split Lock Washer [7], Information Plate [6], and Handwheel [5] from Valve Shaft [3]. Discard Hex Nut [8], Split Lock Washer [7], and Handwheel [5]. Retain Information Plate.
3. Inspect Valve Shaft [3] and clean if necessary, be sure shaft is free of dirt, residue and foreign particles.

**B. Reassembly**

1. Install Handwheel [5], Information Plate [6], Split Lock Washer [7], and Hex Nut [8] onto Valve Shaft [3] and tighten.
2. Connect the Valve Assembly outlet to a pressure source of at least 150 psi. Check for leaks at all joints and stem seals using a suitable leak detector solution such as "Marshall Excelsior" leak detector.

**CAUTION: Do Not Use the valve if any joints continue to leak under pressure.**

**C. Component List**

1. Valve Shaft
2. Handwheel
3. Information Plate
4. Split Lock Washer
5. Hex Nut

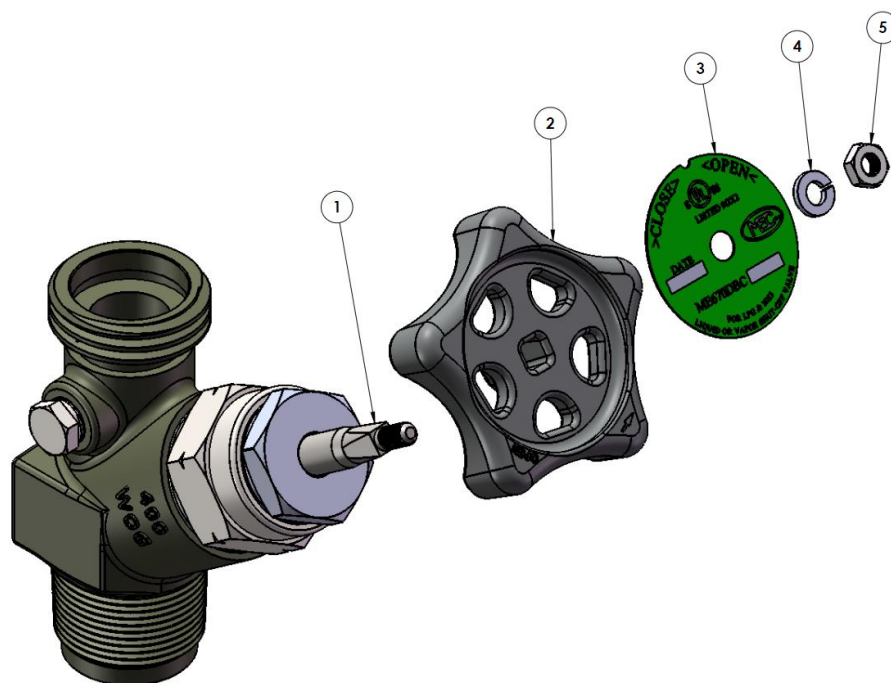

**Marshall Excelsior Company**

1506 George Brown Drive Marshall, MI 49068  
Phone (269) 789-6700 Fax (269) 781-8340  
[www.marshallexcelsior.com](http://www.marshallexcelsior.com)

The contents of this publication are for informational purposes only. While every effort has been made to ensure accuracy, these contents are not to be construed as warranties or guarantees, expressed or implied, regarding the products or services described herein or for their use or applicability. Marshall Excelsior Co. reserves the right to modify or improve the designs or specifications of such products at any time without notice. The MEC™ logo is the trademark of Marshall Excelsior Co.