



**ME990-16-VRK AND ME990-24-VRK  
COMPLETE VALVE REPAIR KIT  
FOR: ME990 2" AND 3" NPT INTERNAL VALVE**

**!!!WARNING!!!**

READ AND UNDERSTAND ALL INSTRUCTIONS INCLUDED WITH THIS REPAIR KIT  
RELIEVE ALL PRESSURE FROM SYSTEM BEFORE REMOVING VALVE FOR SERVICE

**NOTE:** Numbers in brackets [ ] refer to the number in the valve component list.

**A. Disassembly**

1. **EVACUATE ALL PRESSURE FROM SYSTEM BEFORE ANY DISASSEMBLY OR REPAIR.**
2. Remove Valve Link Cotter Pin [15] from Lever [14] and discard.
3. Remove Lever [14] and retain.
4. Remove Gland Assembly [2] and Gland O-Ring [16] from Body [1] and discard.
5. Remove Cotter Pin [13], Locknut [12], Bleed Disc [11], and Valve Holder Assembly [4] from Stem [3] and discard.
6. Remove Excess Flow Spring [10] from Stem [3] and either:
  - a. Discard if you have purchased a new Excess Flow Spring; or
  - b. Retain if you did not purchase a new Excess Flow Spring.
7. Remove Spring Seat [9] from Stem [3] and discard.
8. Remove Stem [3], Lower Washer [6], Closing Spring [7], Upper Washer [8] and Stem Guide [5] from Body [1] and discard.
9. Inspect Valve Body [1] and clean if necessary, be sure interior is free of dirt, residue and foreign particles.

**B. Reassembly**

1. Apply lubriplate to Stem O-Ring [17] and install on Stem [3].
2. Install Lower Washer [6], Closing Spring [7], and Upper Washer [8] on Stem [3].
3. Install Stem Guide [5] on Stem [3] and install in Body [1].
4. Install Spring Seat [9], Excess Flow Spring [10], and Valve Holder Assembly [4] on Stem [3].
5. Apply lubriplate to bore of Bleed Disc [11] and install on Stem [3].
6. Install Locknut [12] on Stem [3].
7. Install Cotter Pin [13] thru hole in Stem [3].
8. Apply Loctite #242 to threads of Gland Assembly [2] and install into Body [1]. Ensure that Gland O-Ring [16] is present and installed properly.
9. Install Lever [14] on Gland Assembly [2] and retain with Valve Link Cotter Pin [15].
10. Connect the valve assembly outlet to a pressure source of at least 150 PSI. Check for leaks at all joints and stem seals using a suitable leak detector solution such as "Marshall Excelsior" leak detector.

**CAUTION: DO NOT USE THE VALVE IF ANY JOINT CONTINUES TO LEAK UNDER PRESSURE.**

**Marshall Excelsior Company**

1506 George Brown Drive Marshall, MI 49068  
Phone (269) 789-6700 Fax (269) 781-8340  
[www.marshallexcelsior.com](http://www.marshallexcelsior.com)

The contents of this publication are for informational purposes only. While every effort has been made to ensure accuracy, these contents are not to be construed as warranties or guarantees, expressed or implied, regarding the products or services described herein or for their use or applicability. Marshall Excelsior Co. reserves the right to modify or improve the designs or specifications of such products at any time without notice. The MEC™ logo is the trademark of Marshall Excelsior Co.

**ME990-16-VRK AND ME990-24-VRK  
COMPLETE VALVE REPAIR KIT  
FOR: ME990 2" AND 3" NPT INTERNAL VALVE**



**WARNING:** These products contain a chemical known to the state of California to cause cancer and birth defects or reproductive harm

### C. Component List

1. Body
2. Gland Assembly
3. Stem
4. Valve Holder Assembly
5. Stem Guide Assembly
6. Lower Washer
7. Closing Spring
8. Upper Washer
9. Spring Seat
10. Excess Flow Spring
11. Bleed Disc
12. Lock Nut
13. Cotter Pin
14. Lever
15. Valve Link Cotter Pin
16. Gland O-Ring
17. Stem O-Ring, not shown

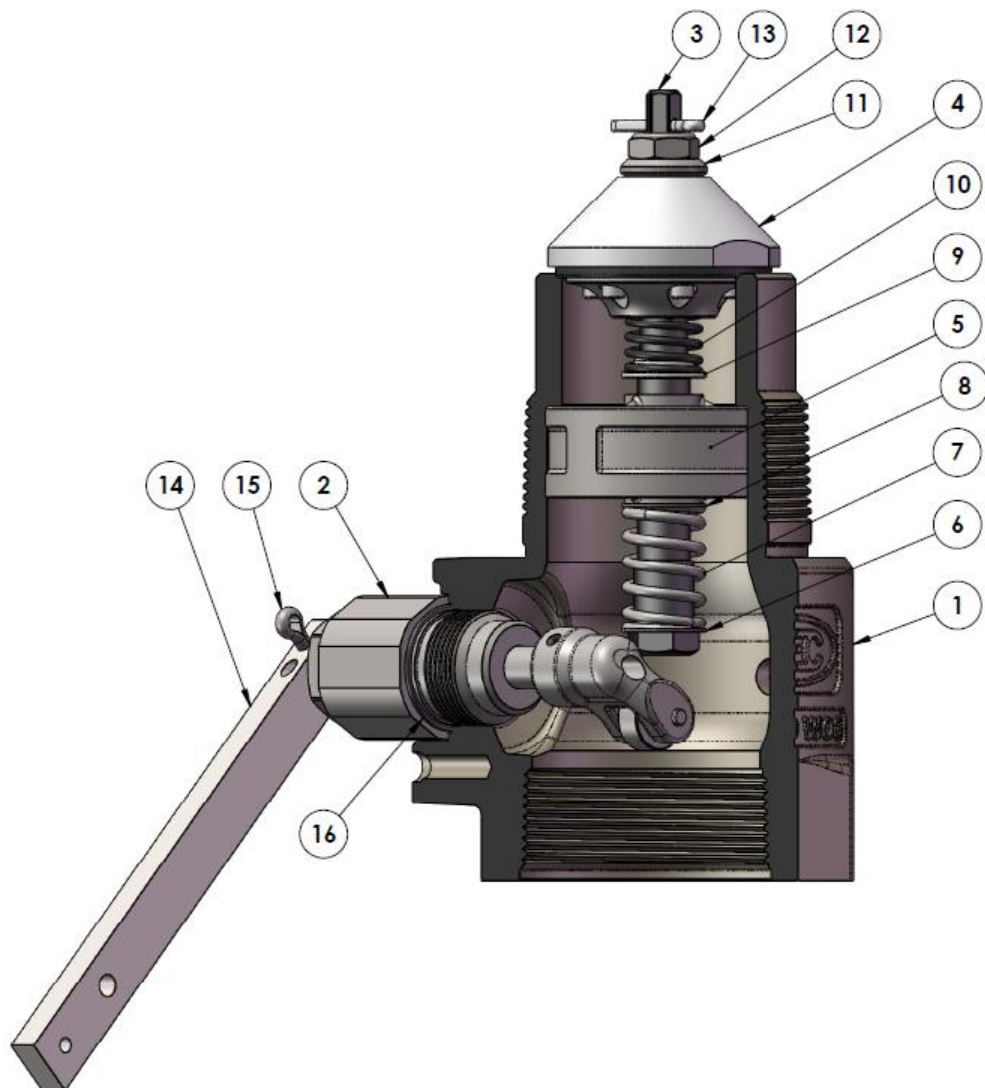

### Marshall Excelsior Company

1506 George Brown Drive Marshall, MI 49068  
Phone (269) 789-6700 Fax (269) 781-8340  
[www.marshallexcelsior.com](http://www.marshallexcelsior.com)

The contents of this publication are for informational purposes only. While every effort has been made to ensure accuracy, these contents are not to be construed as warranties or guarantees, expressed or implied, regarding the products or services described herein or for their use or applicability. Marshall Excelsior Co. reserves the right to modify or improve the designs or specifications of such products at any time without notice. The MEC™ logo is the trademark of Marshall Excelsior Co.