

ME840K
VALVE REPAIR KIT
FOR: 1 1/4" TO 2" SERIES BYPASS VALVE ASSEMBLY

!!!WARNING!!!

READ AND UNDERSTAND ALL INSTRUCTIONS INCLUDED WITH THIS REPAIR KIT
RELIEVE ALL PRESSURE FROM SYSTEM BEFORE REMOVING VALVE FOR SERVICE

NOTE: Numbers in brackets [] refer to the number in the valve component list.



WARNING: These products contain a chemical known to the state of California to cause cancer and birth defects or reproductive harm

A. Disassembly

1. **EVACUATE ALL PRESSURE FROM SYSTEM BEFORE ANY DISASSEMBLY OR REPAIR.**
2. Remove Hex Screw [13] from Flange [12] and discard Hex Screw [13] and Flange O-Ring [11].
3. Remove Cap [10] on top of Bonnet [5] and discard.
4. Loosen Locknut [9] and remove Stem [8] and Locknut [9] from Bonnet [5] and discard.
5. Remove Bonnet [5] from Body [1] and retain.
6. Remove Spring [3] and retain.
7. Remove Poppet [2] from Body [1] and discard.
8. Remove and discard Spring Guide [6] and O-Rings [4 and 7] from Bonnet [5]
9. Inspect Valve Body [1] and Bonnet [5], and clean if necessary, be sure interior is free of dirt, residue and foreign particles.
CAUTION: Do not SCRATCH or MAR seat area in valve body.

B. Reassembly

1. Install Poppet [2] into Body [1].
2. Install Spring [3] onto Poppet [2].
3. Apply silicone grease to Spring Guide

- O-Ring [7] and install Spring Guide [6] onto Spring [3].
4. Apply silicone grease to Bonnet O-Ring [4] and install in groove of Body [1].
5. Install Bonnet [5] into Body [1].
6. Install Stem [8] into Bonnet [5].

Connect the valve assembly outlet to a pressure source of at least 150 PSI. Check for leaks at all joints and Stem seals using a suitable leak detector solution such as "Marshall Excelsior" leak detector. **CAUTION: DO NOT USE THE VALVE IF ANY JOINT CONTINUES TO LEAK UNDER PRESSURE.**

7. Re-adjust set point for Valve and Thread Cap [16] onto Bonnet [5].
8. Apply silicone grease to Flange O-Ring [1] and install into Flanges [12]. Attach Flanges [12] to Body [1] with Hex Screw [13].

C. Valve Component List

1. Body
2. Poppet
3. Spring
4. Bonnet O-Ring
5. Bonnet
6. Spring Guide
7. Spring Guide O-Ring
8. Stem
9. Lock Nut
10. Cap
11. Flange O-Ring, 2 required
12. Flange, 2 required
13. Hex Screw, 8 required
14. 1/4" NPT Plug, 2 required
15. Nameplate
16. Nameplate screw, 2 required

Marshall Excelsior Company

1506 George Brown Drive Marshall, MI 49068
Phone (269) 789-6700 Fax (269) 781-8340
www.marshallexcelsior.com

The contents of this publication are for informational purposes only. While every effort has been made to ensure accuracy, these contents are not to be construed as warranties or guarantees, expressed or implied, regarding the products or services described herein or for their use or applicability. Marshall Excelsior Co. reserves the right to modify or improve the designs or specifications of such products at any time without notice. The MEC™ logo is the trademark of Marshall Excelsior Co.

**ME840-24K
VALVE REPAIR KIT
FOR: ME840-24 SERIES VALVE ASSEMBLY**

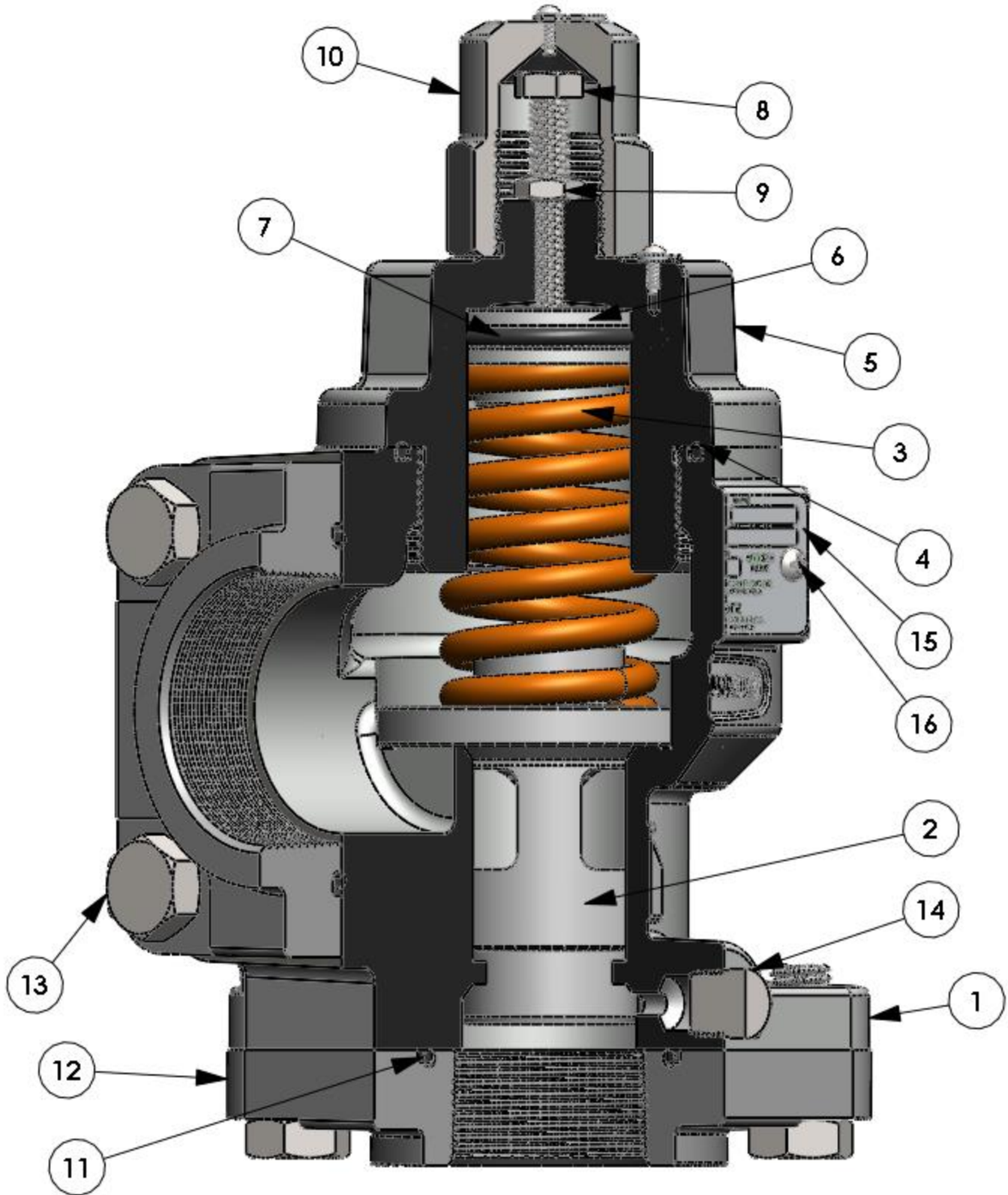

Phone (269) 789-6700 Fax (269) 781-8340
www.marshallexcelsior.com

The contents of this publication are for informational purposes only. While every effort has been made to ensure accuracy, these contents are not to be construed as warranties or guarantees, expressed or implied, regarding the products or services described herein or for their use or applicability. Marshall Excelsior Co. reserves the right to modify or improve the designs or specifications of such products at any time without notice. The MEC™ logo is the trademark of Marshall Excelsior Co.