

NOTE: Numbers in brackets [] refer to the number in the valve component list. Numbers in parenthesis () refer to the quantity of associated parts.



WARNING: These products contain a chemical known to the state of California to cause cancer and birth defects or reproductive harm

A. Disassembly

1. **EVACUATE ALL PRESSURE FROM SYSTEM BEFORE ANY DISASSEMBLY OR REPAIR.**
2. Place Handle [3] in open position.
3. Remove Bonnet Assembly [1] from Body [2].
4. Remove Bonnet Seal [7] and discard.
5. Place Handle [3] in closed position.
6. Remove Toggle Pin [4] from Handle [3], and remove Handle [3] from assembly.
CAUTION: Ensure spring remains compressed during handle removal
7. Decompress Spring [11] and remove Upper Stem [13] from Bonnet [5].
8. Remove Washer [12], (2) Bushing Nests [9], Stem Bushing [10], and Spring [11] from Upper Stem [13] and retain.
9. Remove Valve Holder Assembly [14] from Upper Stem [13] and discard. Retain Upper Stem [13].
NOTE: Heat may be required to break thread seal
10. Remove Washer [12] from Valve Holder Assembly [14].

B. Re-assembly

1. Install Washer [12] onto Valve Holder Assembly [14].
2. Apply Loctite #271 (packet included) to threads on Valve Holder Assembly [14] and install into Upper Stem [13].
3. Apply Lubriplate or equivalent grease to inside of Bonnet [5]. Fill (2) Bushing Nests [9] as shown.

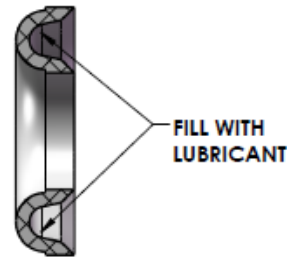

4. Install Spring [11], Washer [12], Stem Bushing [10] and (2) Bushing Nests [9] on Upper Stem [13] as shown.

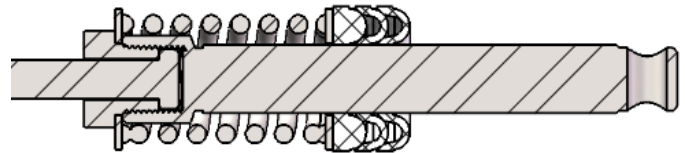

5. Install O-ring [8] and Gasket [6] into Bonnet [5].
6. Install Upper Stem [13] through Bonnet [5] and compress Spring [11] until hole in Upper Stem [13] is exposed. Insert rod into Upper Stem to keep Spring compressed.
7. Install Bonnet Seal [7] into Body [2].
8. Apply Loctite #565 or equivalent thread seal to Bonnet [5] threads and install into Body [2].
9. Remove rod from Upper Stem [13], install Handle [3] onto Upper Stem, and install Toggle Pin [4] through Handle.

Marshall Excelsior Company

1506 George Brown Drive Marshall, MI 49068

Phone (269) 789-6700 Fax (269) 781-8340

www.marshallexcelsior.com

ME800-LSRK

C. Components List

1. Bonnet Assembly
2. Body
3. Handle
4. Toggle Pin
5. Bonnet
6. Gasket
7. Bonnet Seal
8. O-ring
9. Bushing Nest; Qty: 2
10. Stem Bushing
11. Spring
12. Washer; Qty: 2
13. Upper Stem
14. Valve Holder Assembly

