



# ME9000-SEK SENSOR SERVICE KIT INSTRUCTIONS for ME9000LH-17/25 EXCELA-WYND™ HOSE REEL



## BEFORE SERVICING THE EXCELA-WYND™ HOSE REEL PLEASE READ THESE IMPORTANT SAFETY WARNINGS

**WARNING!** Risk of injury from pinch points – Keep hands and fingers away from hose guide.

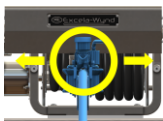

**WARNING!** Risk of injury from pinch points – Do Not operate reel without gear and chain guards in place.



**WARNING!** Risk of injury from pinch / sever points – Keep fingers away from inlet flange.



**WARNING!** - Risk of injury - The hose reel is very heavy. Use a suitable mechanical hoist or crane to lift, move and set reel.



**WARNING!** - Risk of injury - Disconnect power and relieve system pressure prior to servicing reel and controller.



**WARNING!** This product contains a chemical known to the state of California to cause cancer and birth defects or reproductive harm.



**WARNING!** - Failure to follow these instructions or to properly install and maintain this equipment could result in an explosion and/or fire causing property damage and personal injury or death. MEC equipment shall be installed, operated and maintained in accordance with federal, state and local codes, and manufacturer's instructions. The installation in most states shall also comply with NFPA No. 58 and ANSI/CGA-2.1. Only personnel trained in the proper procedures, codes, standards and regulations of the LP-Gas industry should install and service this equipment. Installation or service inconsistent with these instructions may damage the reel, increase the risk of injury or void the warranty.

## REMOVE THE EXISTING SENSOR

- 1) Locate the sensor mounting nuts between the motor and frame rail.
- 2) Using a 9/16" wrench, loosen the locknuts retaining the Sensor Assembly 2 to 3 turns, but don't remove them.
- 3) Remove the sensor body by sliding it out and then rotating it upwards.
- 4) Remove any cable ties securing the conduit.
- 5) Locate the sensor connector at the end of the cable conduit and disconnect it from the extension cable connector (not shown).

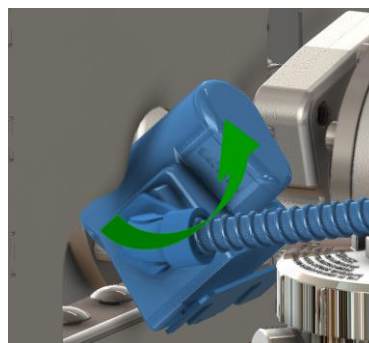
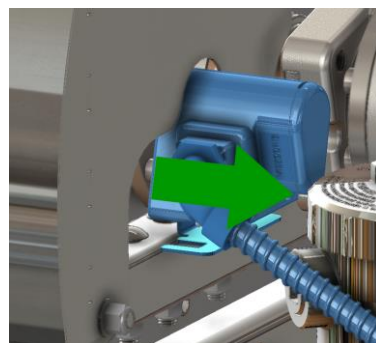
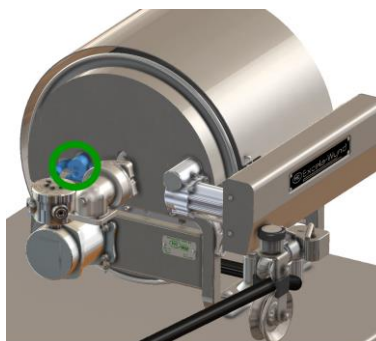

Alternatively, for easier access, the gear guard can be removed using a 9/16" socket:

### A) For Gear Guards secured by Bolts:

- Remove the (2) bolts securing the gear guard and retain the lock washers.

### B) For Gear Guards secured by Locknuts:

- Loosen the locknuts retaining the gear guard 2 to 3 turns, but don't remove them.

- C) Slide the gear guard up and off the reel to access the sensor assembly.

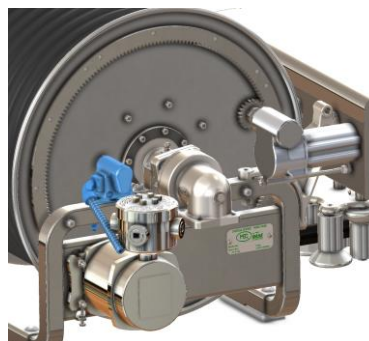



# ME9000-SEK SENSOR SERVICE KIT INSTRUCTIONS for ME9000LH-17/25 EXCELA-WYND™ HOSE REEL



## INSTALL THE NEW SENSOR

- 1) Rotate the sensor into position.
- 2) Align the slots in the sensor bracket with the flats of the carriage bolts.
- 3) While pushing upwards on the locknuts, slide the sensor bracket under the heads of the carriage bolts.
- 4) Push the sensor all the way in until the bracket stops on the carriage bolts and tighten securely. This will position the sensor about 1/8" from the bolt heads.
- 5) Confirm that the reel spool turns freely.
- 6) Connect the Sensor cable connector to the extension cable connector (not shown).

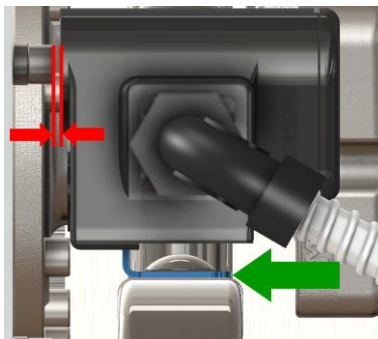
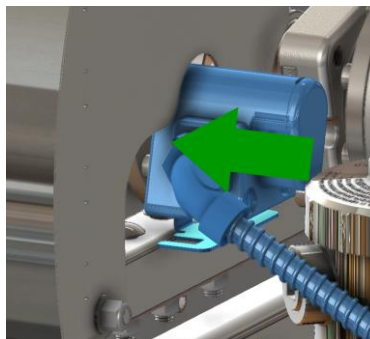
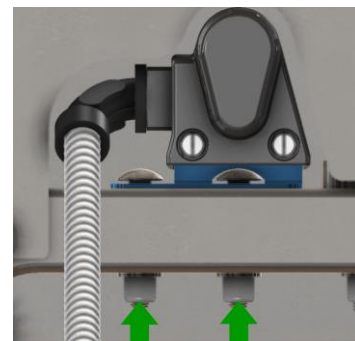
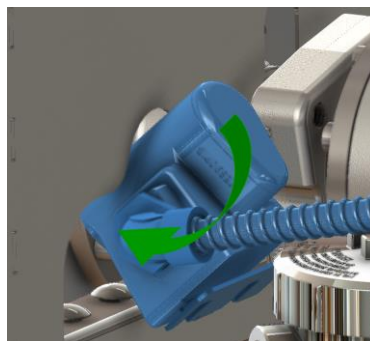

- 7) Confirm that the sensor, controller and reel are operating properly by running the **Test Mode**:  
**Note:** The VSC9000 controller is located in the BASE Engineering enclosure near the truck cab.

- a. Slide DIP switch 7 "ON" to enable test mode.
- b. Set the Park brake and turn on truck ignition.
- c. While watching the LED indicators on the VSC9000 controller:
  - i. Press and release the "REEL OUT" button on the PC3 or ASKW remote. (Yellow LED on controller lights.)
  - ii. Have an associate pull hose off the reel at a fast walking speed.
  - iii. The **Green** LED must turn on and off as the reel rotates. If it doesn't turn on, recheck the connections.
  - iv. If the **Green** LED doesn't turn off, loosen the sensor nuts, slide the sensor outward approximately 1/16" & tighten nuts securely.
- d. Repeat Test Mode until **Green** LED turns on and off as reel rotates.

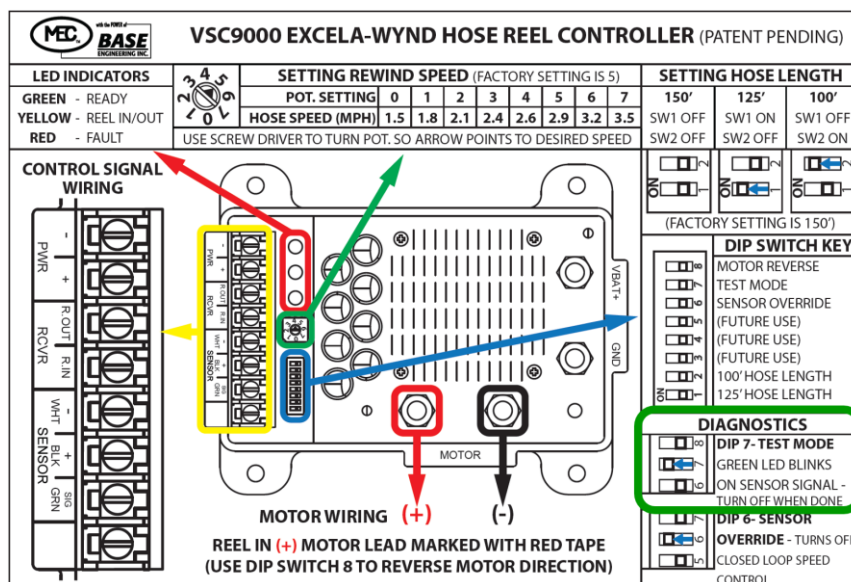

- 8) Turn DIP switch 7 "OFF" when done, press REEL IN button on PC3 or ASKW remote to load hose on reel then turn off truck.
- 9) Secure sensor conduit with cable ties and ensure that sensor / extension cable connector is secure and protected from exposure.
- 10) Reinstall Gear Guard, if removed, by installing bolts and lock washers and tightening securely or by tightening locknuts securely.

Use the camera on your smart phone or device to scan the following QR codes to access additional instructions and videos.

### Form 1176-IOM, Operation and Maintenance Manual



### ME9000-SEK, Sensor Kit Installation VIDEO

