



ME1000-10-SRK INTERNAL COMBINATION VALVE BONNET SEAL REPAIR KIT

!!!WARNING!!!

READ AND UNDERSTAND ALL INSTRUCTIONS INCLUDED WITH THIS REPAIR KIT
RELIEVE ALL PRESSURE FROM SYSTEM BEFORE REMOVING VALVE FOR SERVICE

NOTE: Numbers in brackets [] refer to the number in the valve component list.

!WARNING!

Relieve all pressure from system before removing valve for service, and before any disassembly or repair.

Read and understand all instructions included with the repair kit, prior to starting any repairs.

!GENERAL WARNING!

Marshall Excelsior products are mechanical devices that are subject to wear, contaminants, corrosion, and aging of components made of materials such as rubber and metal. Over time these devices will eventually become inoperative. The safe service life of these products will reflect the environment and conditions of use that they are subjected to. Regular inspection and maintenance is essential. Marshall Excelsior products have a long record of quality and service, so LP-Gas dealers may forget hazards that can arise from using aging devices that have outlived their safe service life.



WARNING: These products contain a chemical known to the state of California to cause cancer and birth defects or reproductive harm

Disassembly

1. Remove Bonnet [10] from Body [11].
2. Remove Bonnet O-ring [1] from Bonnet [10] and discard.
3. Remove Handle Nut [15], Lock Washer [14], Handle Data Plate [13] and Handle [12] from Bonnet [10] and retain.
4. Remove Gland Seal Assembly [2-8] and Spring [9]. Discard all internal Gland Assembly components [2-7]. Retain Gland Holder [8] and Spring.

NOTE: Removed Gland Assembly components may differ from Repair Kit.

5. Inspect Body [11] and Bonnet [10] and clean if necessary. Be sure the interior is free of dirt, residue, and foreign particles.

B. Re-assembly

1. Install Spring [9z] into Bonnet [10].
2. Apply Lubriplate or equivalent grease to Gland O-ring [7] and install onto Gland Holder [8].
3. Apply Lubriplate or equivalent grease to one Wiper O-Ring [4], Male Adapter Bushing [3], and inside of Gland Holder [8].
4. Apply Lubriplate or equivalent grease to outside of Female Adapter [6] and (2) V-Packs [5]. Fill inside of components with lubricant as shown.

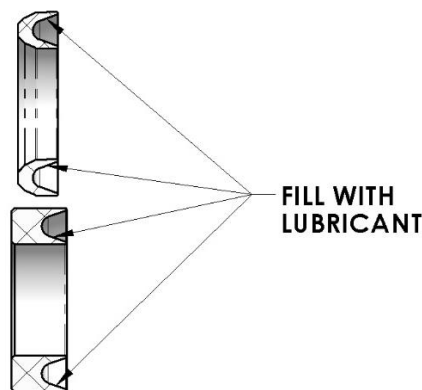

5. Install one Wiper O-Ring [4], Female Adapter [6], (2) V-Packs [5], Bushing O-Ring (cut) [2] and Male Adapter Bushing [3] into Gland Holder [8] as shown below.

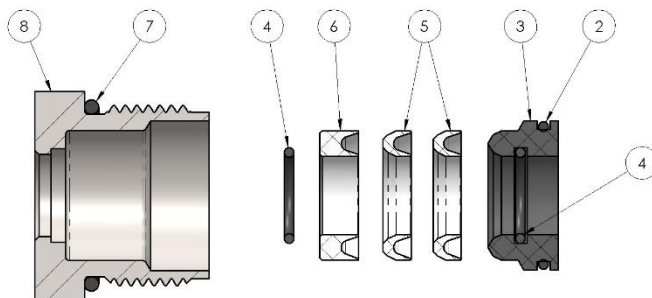

6. Apply Loctite #565 or equivalent thread sealant to threads of Gland Seal Assembly [2-8] and install into Bonnet [10]. Wipe away excess sealant.

Marshall Excelsior Company

1506 George Brown Drive Marshall, MI 49068
Phone (269) 789-6700 Fax (269) 781-8340
www.marshallexcelsior.com

The contents of this publication are for informational purposes only. While every effort has been made to ensure accuracy, these contents are not to be construed as warranties or guarantees, expressed or implied, regarding the products or services described herein or for their use or applicability. Marshall Excelsior Co. reserves the right to modify or improve the designs or specifications of such products at any time without notice. The MEC™ logo is the trademark of Marshall Excelsior Co.

ME1000-10-SRK

7. Install Bonnet O-ring [1] onto Bonnet [10]
8. Apply Loctite #242 or equivalent thread locker to Bonnet [10] threads.
9. Install Bonnet [10] into Body [11] and torque to minimum 50 ft-lbs.
10. Install Handle [12], Handle Data Plate [13], Lock Washer [14], and Handle Nut [15] onto Bonnet [10]. Tighten Handle Nut to 55-65 in-lb torque.
11. Connect the valve assembly outlet to a pressure source of at least 150 PSI. Check for leaks at all joints and at stem seal using a suitable leak detector solution such as “Marshall Excelsior” leak detector.

CAUTION

DO NOT USE THE VALVE IF ANY JOINT CONTINUES TO LEAK UNDER PRESSURE.

Item Number	Description	Qty.	Included in Repair kit
1	Bonnet O-ring	1	Yes
2	Bushing O-ring (cut)	1	Yes
3	Male Adapter Bushing	1	Yes
4	Wiper	2	Yes
5	V-Pack	2	Yes
6	Female Adapter	1	Yes
7	Gland O-ring	1	Yes
8	Gland Holder	1	No
9	Spring	1	No
10	Bonnet Assembly	1	No
11	Body	1	No
12	Handle	1	No
13	Handle Info Plate	1	No
14	Lock Washer	1	No
15	Handle Nut	1	No

ME1000-10-SRK

