

# ME449X-110-KIT CHECK VALVE INSTALLATION AND REPLACEMENT



## !WARNING!

Failure to follow these instructions or to properly install and maintain this equipment could result in an explosion and/or fire causing property damage and personal injury or death.

Install, operate and maintain Marshall Excelsior Co. equipment in accordance with federal, state, and local codes and these instructions. The installation in most states must also comply with NFPA standards 58 and 59.

Only personnel trained in the proper procedures, codes, standards and regulations of the LP-Gas should install, maintain and service this equipment. Be sure all instructions are read and understood before installation, operation and maintenance. These instructions must be passed along to the end user of the product.

## !GENERAL WARNING!

Marshall Excelsior products are mechanical devices that are subject to wear, contaminants, corrosion, and aging of components made of materials such as rubber and metal. Over time these devices will eventually become inoperative. The safe service life of these products will reflect the environment and conditions of use that they are subjected to. Regular inspection and maintenance is essential. Marshall Excelsior products have a long record of quality and service, so LP-Gas dealers may forget hazards that can arise from using aging devices that have outlived their safe service life.

## !CAUTION!

Contact or inhalation of liquid propane and its vapors can cause serious injury or death. LP-gas must be released outdoors in air currents that will insure dispersion to prevent exposure to people and livestock. LP-Gas must be kept far enough from any open flame or other source of ignition to prevent fire or explosion! LP-Gas is heavier than air and will not disperse or evaporate rapidly if released in still air.



**WARNING:** These products contain a chemical known to the state of California to cause cancer and birth defects or reproductive harm

The contents of this publication are for informational purposes only. While every effort has been made to ensure accuracy, these contents are not to be construed as warranties or guarantees, expressed or implied, regarding the products or services described herein or for their uses or applicability. Marshall Excelsior Co. reserves the right to modify or improve the designs or specifications of such products at any time without notice. The MEC™ logo is the trademark of Marshall Excelsior Co.

# ME449X-110-KIT CHECK VALVE INSTALLATION AND REPLACEMENT



## !WARNING!

Failure to follow these instructions or to properly install and maintain this equipment could result in an explosion and/or fire causing property damage and personal injury or death.

Install, operate and maintain Marshall Excelsior Co. equipment in accordance with federal, state, and local codes and these instructions. The installation in most states must also comply with NFPA standards 58 and 59.

Only personnel trained in the proper procedures, codes, standards and regulations of the LP-Gas should install, maintain and service this equipment. Be sure all instructions are read and understood before installation, operation and maintenance. These instructions must be passed along to the end user of the product.

## !GENERAL WARNING!

Marshall Excelsior products are mechanical devices that are subject to wear, contaminants, corrosion, and aging of components made of materials such as rubber and metal. Over time these devices will eventually become inoperative. The safe service life of these products will reflect the environment and conditions of use that they are subjected to. Regular inspection and maintenance is essential. Marshall Excelsior products have a long record of quality and service, so LP-Gas dealers may forget hazards that can arise from using aging devices that have outlived their safe service life.

## !CAUTION!

Contact or inhalation of liquid propane and its vapors can cause serious injury or death. LP-gas must be released outdoors in air currents that will insure dispersion to prevent exposure to people and livestock. LP-Gas must be kept far enough from any open flame or other source of ignition to prevent fire or explosion! LP-Gas is heavier than air and will not disperse or evaporate rapidly if released in still air.



**WARNING:** These products contain a chemical known to the state of California to cause cancer and birth defects or reproductive harm

The contents of this publication are for informational purposes only. While every effort has been made to ensure accuracy, these contents are not to be construed as warranties or guarantees, expressed or implied, regarding the products or services described herein or for their uses or applicability. Marshall Excelsior Co. reserves the right to modify or improve the designs or specifications of such products at any time without notice. The MEC™ logo is the trademark of Marshall Excelsior Co.

## SCOPE OF THE MANUAL

This manual covers the replacement or addition of the ME449X-110-KIT Check Valve into a valve with a 3/4" – 28 threaded connection.

## INTRODUCTION

The M449X-110-KIT Check Valve is designed to restrict and cut off LPG flow above 19.5 GPM. The valve contains a weep feature to equalize pressure after flow has been restricted.

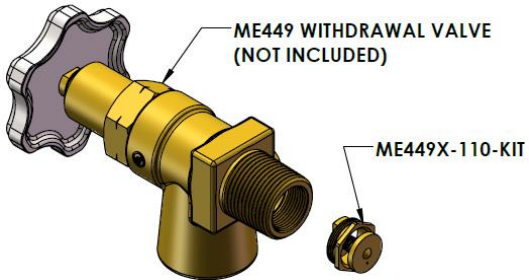

## CHECK VALVE INSTALLATION AND REPLACEMENT

1. Remove all traces of LP gas from the valve per the procedures specified in National Fire Protection Association Pamphlet #58.
2. Before installation, verify function of replacement Check Valve by pressing valve poppet to closed and releasing several times. Verify Check Valve operates without binding and returns to the full-open position after operation.
3. Remove any existing Check Valve if applicable.
4. Clean any existing thread-locking residue from the female threads of the installation point.
5. Apply a high-strength thread locker (Loctite #271 or equivalent) to threads of Check Valve. Install Check Valve into valve connection and tighten to 10-20 in-lb torque.
6. **For ME449 Withdrawal valves:** stamp or otherwise permanently mark "ME449X/19.5" on one hex flat of the valve.

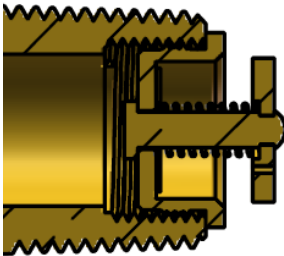

## CHECK VALVE TESTING

1. After installation, press the Check Valve poppet to closed and release several times. Verify Check Valve continues to operate without binding and returns to the full-open position after operation.

## SCOPE OF THE MANUAL

This manual covers the replacement or addition of the ME449X-110-KIT Check Valve into a valve with a 3/4" – 28 threaded connection.

## INTRODUCTION

The M449X-110-KIT Check Valve is designed to restrict and cut off LPG flow above 19.5 GPM. The valve contains a weep feature to equalize pressure after flow has been restricted.

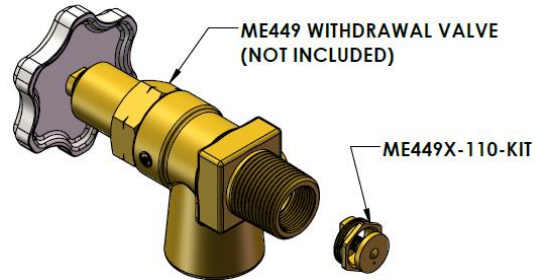

## CHECK VALVE INSTALLATION AND REPLACEMENT

1. Remove all traces of LP gas from the valve per the procedures specified in National Fire Protection Association Pamphlet #58.
2. Before installation, verify function of replacement Check Valve by pressing valve poppet to closed and releasing several times. Verify Check Valve operates without binding and returns to the full-open position after operation.
3. Remove any existing Check Valve if applicable.
4. Clean any existing thread-locking residue from the female threads of the installation point.
5. Apply a high-strength thread locker (Loctite #271 or equivalent) to threads of Check Valve. Install Check Valve into valve connection and tighten to 10-20 in-lb torque.
6. **For ME449 Withdrawal valves:** stamp or otherwise permanently mark "ME449X/19.5" on one hex flat of the valve.

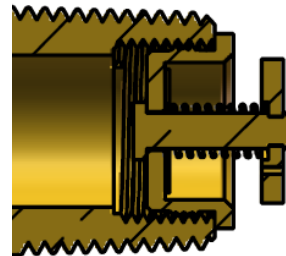

## CHECK VALVE TESTING

1. After installation, press the Check Valve poppet to closed and release several times. Verify Check Valve continues to operate without binding and returns to the full-open position after operation.