

MEP998
EXCELA-FLANGE™
COMPANION FLANGE
ADAPTER KIT



!!! WARNING !!!

Failure to follow these instructions or to properly install and maintain this equipment could result in an explosion and/or fire causing property damage and personal injury or death.

Install, operate and maintain Marshall Excelsior Co. equipment in accordance with federal, state, and local codes and these instructions. The installation in most states must also comply with NFPA #58, ANSI K61.1 and DOT standards.

Only personnel trained in the proper procedures, codes, standards, and regulations of the LP Gas or anhydrous ammonia (NH3) industries should install and service this equipment.



WARNING: These products contain a chemical known to the state of California to cause cancer and birth defects or reproductive harm

!!! CAUTION !!!

- Always wear suitable eye protection, gloves and protective clothing when operating or servicing LPG and NH3 equipment.
- Check seals, seats and threads for wear and damage before use. Repair or replace all defective parts immediately.
- Always completely relieve system or line pressure prior to servicing equipment and plumbing.
- Regular inspection and maintenance is essential for continued safe operation.

Introduction

Scope of the Manual

This manual covers instructions for the MEP998 Companion Flange Adapter kit. This kit allows for the connection of a pump auxiliary inlet to a Marshall Excelsior Co. standard 2" flanged product.

Description

The MEP998 Marshall Excelsior Co. Companion Flange Adapter is designed to connect to larger pressure sources, such as the opening of a pump, and reduce the piping size from a 3" connection down to a 2" connection in order to connect to the rest of the Marshall Excelsior Co. Excela-Flange™ product line.

Installation

1. To install a flange kit, first remove the panel covering the pump's 3" auxiliary inlet; retain (4) Pump Bolts [1] for installation of the kit.

The contents of this publication are for informational purposes only. While every effort has been made to ensure accuracy, these contents are not to be construed as warranties or guarantees, expressed or implied, regarding the products or services described herein or for their uses or applicability. Marshall Excelsior Co. reserves the right to modify or improve the designs or specifications of such products at any time without notice. The MEC™ logo is the trademark of Marshall Excelsior Co.

MEP998
EXCELA-FLANGE™
COMPANION FLANGE
ADAPTER KIT



!!! WARNING !!!

Failure to follow these instructions or to properly install and maintain this equipment could result in an explosion and/or fire causing property damage and personal injury or death.

Install, operate and maintain Marshall Excelsior Co. equipment in accordance with federal, state, and local codes and these instructions. The installation in most states must also comply with NFPA #58, ANSI K61.1 and DOT standards.

Only personnel trained in the proper procedures, codes, standards, and regulations of the LP Gas or anhydrous ammonia (NH3) industries should install and service this equipment.



WARNING: These products contain a chemical known to the state of California to cause cancer and birth defects or reproductive harm

!!! CAUTION !!!

- Always wear suitable eye protection, gloves and protective clothing when operating or servicing LPG and NH3 equipment.
- Check seals, seats and threads for wear and damage before use. Repair or replace all defective parts immediately.
- Always completely relieve system or line pressure prior to servicing equipment and plumbing.
- Regular inspection and maintenance is essential for continued safe operation.

Introduction

Scope of the Manual

This manual covers instructions for the MEP998 Companion Flange Adapter kit. This kit allows for the connection of a pump auxiliary inlet to a Marshall Excelsior Co. standard 2" flanged product.

Description

The MEP998 Marshall Excelsior Co. Companion Flange Adapter is designed to connect to larger pressure sources, such as the opening of a pump, and reduce the piping size from a 3" connection down to a 2" connection in order to connect to the rest of the Marshall Excelsior Co. Excela-Flange™ product line.

Installation

1. To install a flange kit, first remove the panel covering the pump's 3" auxiliary inlet; retain (4) Pump Bolts [1] for installation of the kit.

The contents of this publication are for informational purposes only. While every effort has been made to ensure accuracy, these contents are not to be construed as warranties or guarantees, expressed or implied, regarding the products or services described herein or for their uses or applicability. Marshall Excelsior Co. reserves the right to modify or improve the designs or specifications of such products at any time without notice. The MEC™ logo is the trademark of Marshall Excelsior Co.

!!! WARNING !!!

Release all downstream pressure before removing any bolts, panels, etc. from the system. Failure to follow these instructions or properly install and maintain this equipment could result in an explosion and/or fire causing property damage and personal injury or death.

2. Apply Lubriplate or equivalent grease to Large O-ring [2] and install into larger groove on Companion Flange [3].
3. Install Companion Flange [3] against pump auxiliary inlet; install (4) Pump Bolts [1] to retain.
4. Apply Lubriplate or equivalent grease to Small O-ring [4] and install into remaining groove on Companion Flange [1].
5. Install (4) Flange Bolts [5] through Companion Flange [1] into a Marshall Excelsior Co. Excelsa-Flange™ product.

Maintenance

Marshall Excelsior Co. recommends that if either connection on the Companion Flange Kit should be removed, the O-ring seal for that connection should be replaced.

Component List

1. Pump Bolt (retained during installation); Qty: 4
2. Large O-ring
3. Companion Flange
4. Small O-ring
5. Flange Bolts (contained in kit); Qty: 4

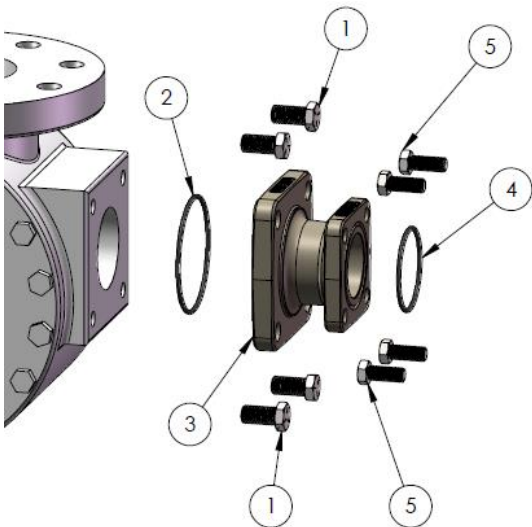

There are developing trends in state legislation and proposed national legislation making the owner of products responsible for replacing products before they outlive their safe service life. LP-Gas dealers should be aware of such legislation as it affects them.

!!! WARNING !!!

Release all downstream pressure before removing any bolts, panels, etc. from the system. Failure to follow these instructions or properly install and maintain this equipment could result in an explosion and/or fire causing property damage and personal injury or death.

- Apply Lubriplate or equivalent grease to Large O-ring [2] and install into larger groove on Companion Flange [3].
2. Install Companion Flange [3] against pump auxiliary inlet; install (4) Pump Bolts [1] to retain.
 3. Apply Lubriplate or equivalent grease to Small O-ring [4] and install into remaining groove on Companion Flange [1].
 4. Install (4) Flange Bolts [5] through Companion Flange [1] into a Marshall Excelsior Co. Excelsa-Flange™ product.

Maintenance

Marshall Excelsior Co. recommends that if either connection on the Companion Flange Kit should be removed, the O-ring seal for that connection should be replaced.

Component List

1. Pump Bolt (retained during installation); Qty: 4
2. Large O-ring
3. Companion Flange
4. Small O-ring
5. Flange Bolts (contained in kit); Qty: 4

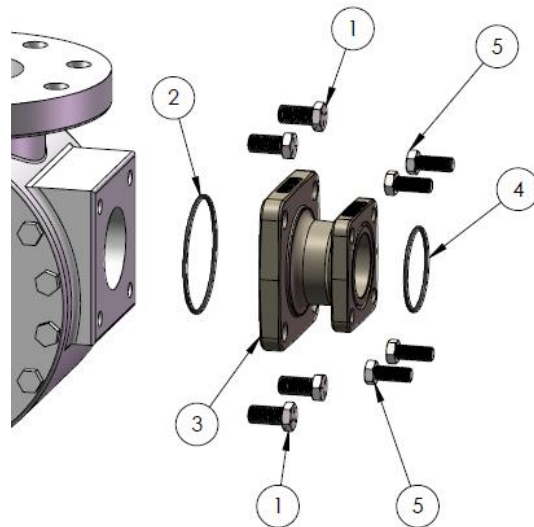

There are developing trends in state legislation and proposed national legislation making the owner of products responsible for replacing products before they outlive their safe service life. LP-Gas dealers should be aware of such legislation as it affects them.