



LPG & NH₃
HIGH CAPACITY FILTER
INSTALLATION & OPERATING INSTRUCTIONS
LPG & NH₃ Filling Station Applications

1506 George Brown Drive
Marshall, MI 49068
Phone (269) 789-6700
Fax (269) 781-8340

APPLICATION

The ME680 Series is designed for protecting critical components in LPG & NH₃ Dispensing systems. Contaminants may come from LPG/NH₃ dispensers and storage facilities. The ME680 Series particulate filter is specifically designed to remove solid contamination from liquid propane or anhydrous ammonia.

FEATURES

- High grade forged aluminum body construction
- Durable powder coated exterior
- Minimum burst pressure of 2500 psig
- 1" hex nut on bottom of bowl for easy maintenance
- 5/16-18 UNC tapped mounting holes for easy installation
- 35 GPM/LPG @ 6.2 PSI pressure differential
- Removes solid contaminants from LPG & NH₃
- Pleated element offers higher contaminant loading capacity and lower pressure drop

INSTALLATION

1. The ME680 Series can be located anywhere in the liquid system. This provides protection to the tank, vaporizer, valves, pumps, fuel rail(s), and injector(s).
2. Mount the filter in an accessible protected location for easy servicing. Use connections appropriate for LPG or NH₃ service.
3. Install liquid lines with the flow entering the filter into the inlet port. Test for leaks, using MEC low temperature leak test solution or leak check using electronic detector.



SERVICE

CAUTION: The ME680 Series must not be under pressure during servicing. Doing so may cause serious injury. Depressurize the system according to the manufacturer's recommendations. Verify the pressure has been relieved by using a pressure gauge known to be in good working order.

Replacing the element: Change the element when differential pressure across the filter reaches 22 PSI (1.5 BAR). Depressurize housing before servicing. Using a 1" hex socket wrench, unscrew bowl and remove old element and O-ring. Lightly lubricate the new O-ring and replace with new components and re-install bowl. Torque to 50 ft-lbs [67 N-m]. Test for leaks with system pressurized by using MEC low temperature leak detection fluid or vapor detection equipment.

The contents of this publication are for informational purposes only. While every effort has been made to ensure accuracy, these contents are not to be construed as warranties or guarantees, expressed or implied, regarding the products or services described herein or for their use or applicability. Marshall Excelsior Co. reserves the right to modify or improve the designs or specifications of such products at any time without notice. The MEC™ logo is the trademark of Marshall Excelsior Co.

SPECIFICATIONS

Maximum Rated Operating Pressure:	350 psig [24 bar]
Operating Temperature:	-40° F to 175° F [-40° to 79° C]
Port Size:	1" NPTF
Element Particulate Rating:	20 µm

REPLACEMENT PARTS

Part Number	Description
ME680-8-ERK	Replacement element, O-rings kits

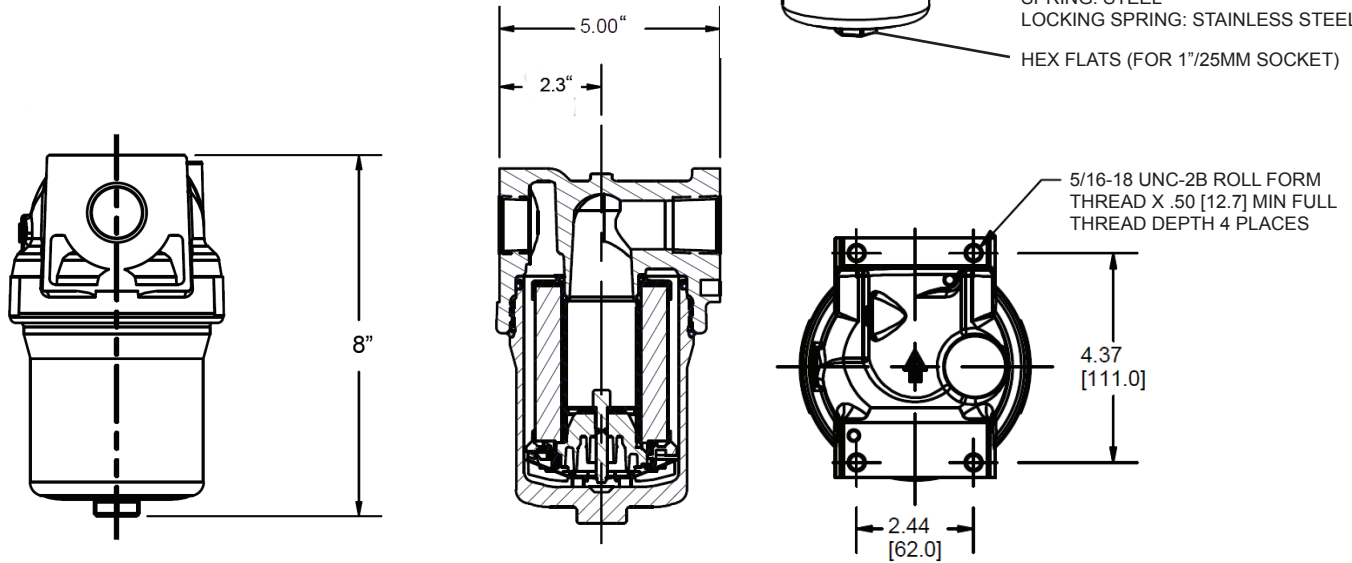
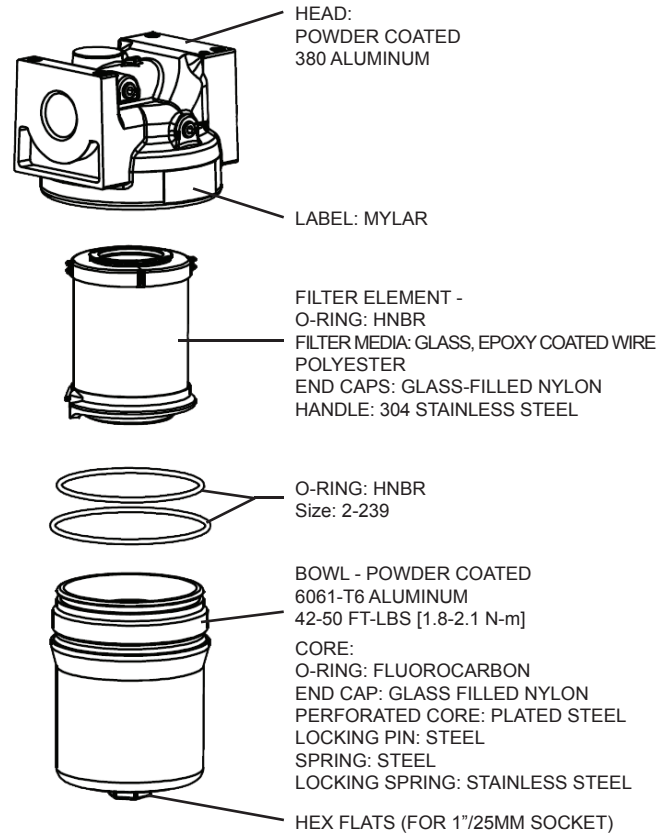

NOTES

1. A minimum 1.4" [35mm] clearance below bowl is required for element removal
2. All dimensions are +/- 0.02" (0.5mm) unless otherwise noted
3. Head/bowl torque specification: 42-50 ft-lbs [1.8-2.1 N-m]
4. Units are shown in inches [mm]

The contents of this publication are for informational purposes only. While every effort has been made to ensure accuracy, these contents are not to be construed as warranties or guarantees, expressed or implied, regarding the products or services described herein or for their use or applicability. Marshall Excelsior Co. reserves the right to modify or improve the designs or specifications of such products at any time without notice. The MEC™ logo is the trademark of Marshall Excelsior Co.